

# VOLUJICA

# GORAN

- LEGENDA:**
- Stambeni objekt
  - Objekt (rusevina)
  - Objekt u prizemlju
  - Drevni objekt
  - Objekt u izgradnji
  - Trafika (kiosk)
  - Sepenice
  - Terasa nadkrivena
  - Terasa otkrivena
  - Zicna ograda
  - Zid kao ograda
  - Gozdena ograda na zidu
  - Ziva ograda
  - Zid od naslaganog kamena
  - Zicna ograda na zidu
  - Sobracajni znakovi
  - Bilbord
  - Semafor
  - Sahte
  - Ulicna rasvjeta
  - Slavnik
  - Bunar
  - Cesma
  - Livada, travnjak
  - Drevni elektro stub
  - Betonski elektro stub
  - Trafo betonski
  - Dalekovidni gradbeni
  - PTT ormar
  - Elektricna kutija
  - Maslina
  - Palma
  - Sponenik
  - Hidrant
  - Granica zahvata
  - Katastarski podaci
  - Izohipse

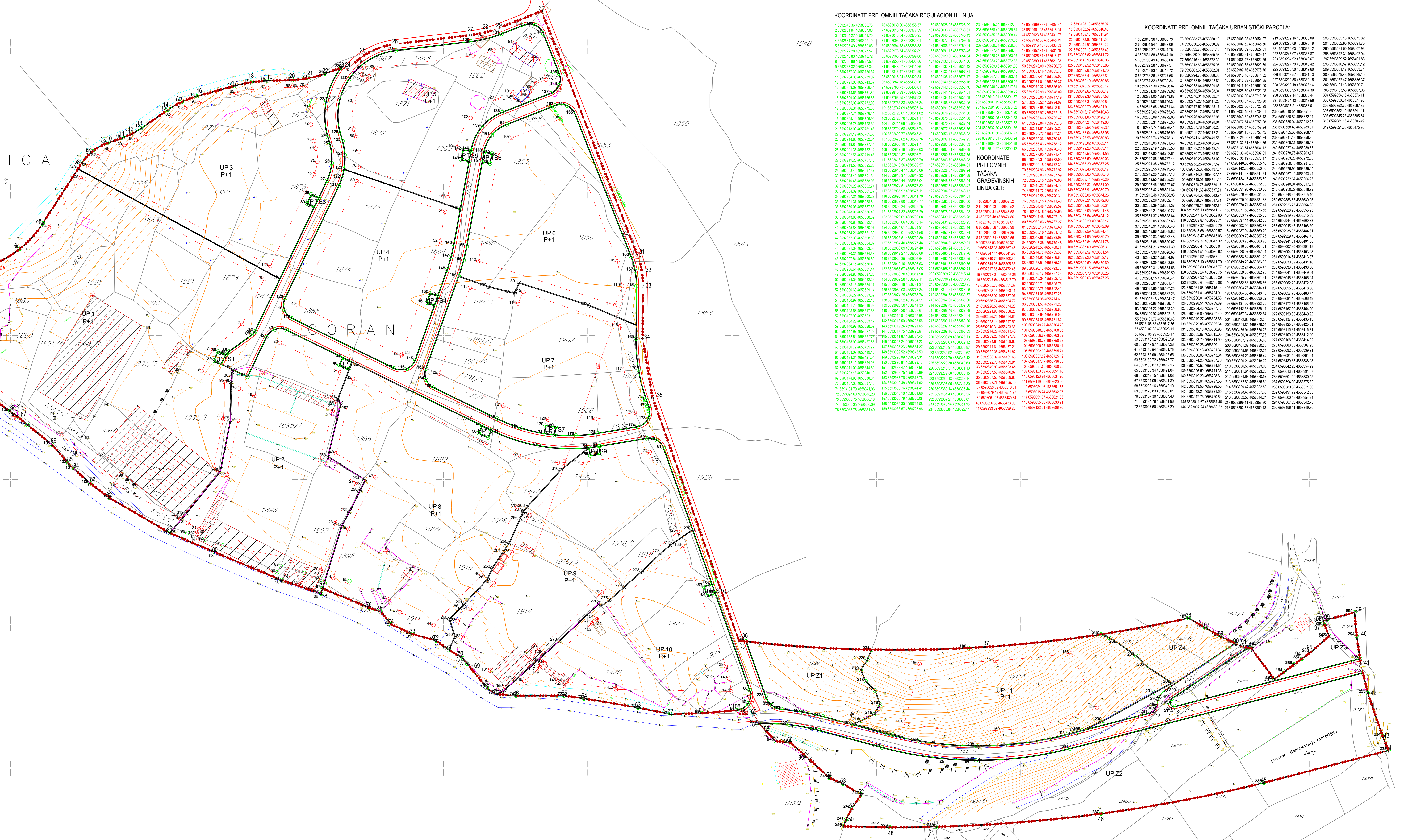

### KOORDINATE PRELOMNIH TAČKA REGULACIONIH LINIJA:

1 690546.36 465803.73	76 690533.00 465835.57	103 690535.00 465872.90	230 690505.04 465871.26	42 690260.76 465877.87	117 690125.10 465875.97
2 690551.94 465807.02	77 690534.44 465837.30	101 690533.45 465873.61	231 690505.49 465871.64	43 690261.95 465878.54	118 690126.15 465876.62
3 690556.92 465810.36	78 690535.98 465838.01	102 690534.99 465874.32	232 690506.93 465872.35	44 690263.14 465879.21	119 690127.20 465877.27
4 690561.90 465813.70	79 690537.52 465838.72	104 690536.53 465875.03	233 690507.37 465873.06	45 690264.33 465879.88	120 690128.25 465877.92
5 690566.88 465817.04	80 690539.06 465839.43	105 690538.07 465875.74	234 690507.81 465873.77	46 690265.52 465880.55	121 690129.30 465878.57
6 690571.86 465820.38	81 690540.60 465840.14	106 690539.61 465876.45	235 690508.25 465874.48	47 690266.71 465881.22	122 690130.35 465879.22
7 690576.84 465823.72	82 690542.14 465840.85	107 690541.15 465877.16	236 690508.69 465875.19	48 690267.90 465881.89	123 690131.40 465879.87
8 690581.82 465827.06	83 690543.68 465841.56	108 690542.69 465877.87	237 690509.13 465875.90	49 690269.09 465882.56	124 690132.45 465880.52
9 690586.80 465830.40	84 690545.22 465842.27	109 690544.23 465878.58	238 690509.57 465876.61	50 690270.28 465883.23	125 690133.50 465881.17
10 690591.78 465833.74	85 690546.76 465842.98	110 690545.77 465879.29	239 690510.01 465877.32	51 690271.47 465883.90	126 690134.55 465881.82
11 690596.76 465837.08	86 690548.30 465843.69	111 690546.78 465879.99	240 690510.45 465878.03	52 690272.66 465884.57	127 690135.60 465882.47
12 690601.74 465840.42	87 690549.84 465844.40	112 690547.79 465880.70	241 690510.89 465878.74	53 690273.85 465885.24	128 690136.65 465883.12
13 690606.72 465843.76	88 690551.38 465845.11	113 690548.80 465881.41	242 690511.33 465879.45	54 690275.04 465885.91	129 690137.70 465883.77
14 690611.70 465847.10	89 690552.92 465845.82	114 690549.81 465882.12	243 690511.77 465880.16	55 690276.23 465886.58	130 690138.75 465884.42
15 690616.68 465850.44	90 690554.46 465846.53	115 690550.82 465882.83	244 690512.21 465880.87	56 690277.42 465887.25	131 690139.80 465885.07
16 690621.66 465853.78	91 690556.00 465847.24	116 690551.83 465883.54	245 690512.65 465881.58	57 690278.61 465887.92	132 690140.85 465885.72
17 690626.64 465857.12	92 690557.54 465847.95	117 690552.84 465884.25	246 690513.09 465882.29	58 690279.80 465888.59	133 690141.90 465886.37
18 690631.62 465860.46	93 690559.08 465848.66	118 690553.85 465884.96	247 690513.53 465883.00	59 690281.00 465889.26	134 690142.95 465887.02
19 690636.60 465863.80	94 690560.62 465849.37	119 690554.86 465885.67	248 690513.97 465883.71	60 690282.19 465889.93	135 690144.00 465887.67
20 690641.58 465867.14	95 690562.16 465850.08	120 690555.87 465886.38	249 690514.41 465884.42	61 690283.38 465890.60	136 690145.05 465888.32
21 690646.56 465870.48	96 690563.70 465850.79	121 690556.88 465887.09	250 690514.85 465885.13	62 690284.57 465891.27	137 690146.10 465888.97
22 690651.54 465873.82	97 690565.24 465851.50	122 690557.89 465887.80	251 690515.29 465885.84	63 690285.76 465891.94	138 690147.15 465889.62
23 690656.52 465877.16	98 690566.78 465852.21	123 690558.90 465888.51	252 690515.73 465886.55	64 690286.95 465892.61	139 690148.20 465890.27
24 690661.50 465880.50	99 690568.32 465852.92	124 690559.91 465889.22	253 690516.17 465887.26	65 690288.14 465893.28	140 690149.25 465890.92
25 690666.48 465883.84	100 690569.86 465853.63	125 690560.92 465889.93	254 690516.61 465887.97	66 690289.33 465893.95	141 690150.30 465891.57
26 690671.46 465887.18	101 690571.40 465854.34	126 690561.93 465890.64	255 690517.05 465888.68	67 690290.52 465894.62	142 690151.35 465892.22
27 690676.44 465890.52	102 690572.94 465855.05	127 690562.94 465891.35	256 690517.49 465889.39	68 690291.71 465895.29	143 690152.40 465892.87
28 690681.42 465893.86	103 690574.48 465855.76	128 690563.95 465892.06	257 690517.93 465890.10	69 690292.90 465895.96	144 690153.45 465893.52
29 690686.40 465897.20	104 690576.02 465856.47	129 690564.96 465892.77	258 690518.37 465890.81	70 690294.09 465896.63	145 690154.50 465894.17
30 690691.38 465900.54	105 690577.56 465857.18	130 690565.97 465893.48	259 690518.81 465891.52	71 690295.28 465897.30	146 690155.55 465894.82
31 690696.36 465903.88	106 690579.10 465857.89	131 690566.98 465894.19	260 690519.25 465892.23	72 690296.47 465897.97	147 690156.60 465895.47
32 690701.34 465907.22	107 690580.64 465858.60	132 690567.99 465894.90	261 690519.69 465892.94	73 690297.66 465898.64	148 690157.65 465896.12
33 690706.32 465910.56	108 690582.18 465859.31	133 690569.00 465895.61	262 690520.13 465893.65	74 690298.85 465899.31	149 690158.70 465896.77
34 690711.30 465913.90	109 690583.72 465860.02	134 690570.01 465896.32	263 690520.57 465894.36	75 690299.04 465900.00	150 690159.75 465897.42
35 690716.28 465917.24	110 690585.26 465860.73	135 690571.02 465897.03	264 690521.01 465895.07	76 690300.23 465900.67	151 690160.80 465898.07
36 690721.26 465920.58	111 690586.80 465861.44	136 690572.03 465897.74	265 690521.45 465895.78	77 690301.42 465901.34	152 690161.85 465898.72
37 690726.24 465923.92	112 690588.34 465862.15	137 690573.04 465898.45	266 690521.89 465896.49	78 690302.61 465902.01	153 690162.90 465899.37
38 690731.22 465927.26	113 690589.88 465862.86	138 690574.05 465899.16	267 690522.33 465897.20	79 690303.80 465902.68	154 690163.95 465900.02
39 690736.20 465930.60	114 690591.42 465863.57	139 690575.06 465899.87	268 690522.77 465897.91	80 690304.99 465903.35	155 690165.00 465900.67
40 690741.18 465933.94	115 690592.96 465864.28	140 690576.07 465900.58	269 690523.21 465898.62	81 690306.18 465904.02	156 690166.05 465901.32
41 690746.16 465937.28	116 690594.50 465864.99	141 690577.08 465901.29	270 690523.65 465899.33	82 690307.37 465904.69	157 690167.10 465901.97
42 690751.14 465940.62	117 690596.04 465865.70	142 690578.09 465902.00	271 690524.09 465899.64	83 690308.56 465905.36	158 690168.15 465902.62
43 690756.12 465943.96	118 690597.58 465866.41	143 690579.10 465902.71	272 690524.53 465900.35	84 690309.75 465906.03	159 690169.20 465903.27
44 690761.10 465947.30	119 690599.12 465867.12	144 690580.11 465903.42	273 690524.97 465901.06	85 690310.94 465906.70	160 690170.25 465903.92
45 690766.08 465950.64	120 690600.66 465867.83	145 690581.12 465904.13	274 690525.41 465901.77	86 690312.13 465907.37	161 690171.30 465904.57
46 690771.06 465953.98	121 690602.20 465868.54	146 690582.13 465904.84	275 690525.85 465902.48	87 690313.32 465908.04	162 690172.35 465905.22
47 690776.04 465957.32	122 690603.74 465869.25	147 690583.14 465905.55	276 690526.29 465903.19	88 690314.51 465908.71	163 690173.40 465905.87
48 690781.02 465960.66	123 690605.28 465869.96	148 690584.15 465906.26	277 690526.73 465903.90	89 690315.70 465909.38	164 690174.45 465906.52
49 690786.00 465964.00	124 690606.82 465870.67	149 690585.16 465906.97	278 690527.17 465904.61	90 690316.89 465910.05	165 690175.50 465907.17
50 690790.98 465967.34	125 690608.36 465871.38	150 690586.17 465907.68	279 690527.61 465905.32	91 690318.08 465910.72	166 690176.55 465907.82
51 690795.96 465970.68	126 690609.90 465872.09	151 690587.18 465908.39	280 690528.05 465906.03	92 690319.27 465911.39	167 690177.60 465908.47
52 690800.94 465974.02	127 690611.44 465872.80	152 690588.19 465909.10	281 690528.49 465906.74	93 690320.46 465912.06	168 690178.65 465909.12
53 690805.92 465977.36	128 690612.98 465873.51	153 690589.20 465909.81	282 690528.93 465907.45	94 690321.65 465912.73	169 690179.70 465909.77
54 690810.90 465980.70	129 690614.52 465874.22	154 690590.21 465910.52	283 690529.37 465908.16	95 690322.84 465913.40	170 690180.75 465910.42
55 690815.88 465984.04	130 690616.06 465874.93	155 690591.22 465911.23	284 690529.81 465908.87	96 690324.03 465914.07	171 690181.80 465911.07
56 690820.86 465987.38	131 690617.60 465875.64	156 690592.23 465911.94	285 690530.25 465909.58	97 690325.22 465914.74	172 690182.85 465911.72
57 690825.84 465990.72	132 690619.14 465876.35	157 690593.24 465912.65	286 690530.69 465910.29	98 690326.41 465915.41	173 690183.90 465912.37
58 690830.82 465994.06	133 690620.68 465877.06	158 690594.25 465913.36	287 690531.13 465911.00	99 690327.60 465916.08	174 690184.95 465913.02
59 690835.80 465997.40	134 690622.22 465877.77	159 690595.26 465914.07	288 690531.57 465911.71	100 690328.79 465916.75	175 690186.00 465913.67
60 690840.78 466000.74	135 690623.76 465878.48	160 690596.27 465914.78	289 690532.01 465912.42	101 690329.98 465917.42	176 690187.05 465914.32
61 690845.76 466004.08	136 690625.30 465879.19	161 690597.28 465915.49	290 690532.45 465913.13	102 690331.17 465918.09	177 690188.10 465914.97
62 690850.74 466007.42	137 690626.84 465879.90	162 690598.29 465916.20	291 690532.89 465913.84	103 690332.36 465918.76	178 690189.15 465915.62
63 690855.72 466010.76	138 690628.38 465880.61	163 690599.30 465916.91	292 690533.33 465914.55	104 690333.55 465919.43	179 690190.20 465916.27
64 690860.70 466014.10	139 690629.92 465881.32	164 690600.31 465917.62	293 690533.77 465915.26	105 690334.74 465920.10	180 690191.25 465916.92
65 690865.68 466017.44	140 690631.46 465882.03	165 690601.32 465918.33	294 690534.21 465915.97	106 690335.93 465920.77	181 690192.30 465917.57
66 690870.66 466020.78	141 690633.00 465882.74	166 690602.33 465919.04	295 690534.65 465916.68	107 690337.12 465921.44	182 690193.35 465918.22
67 690875.64 466024.12	142 690634.54 465883.45	167 690603.34 465919.75	296 690535.09 465917.39	108 690338.31 465922.11	183 690194.40 465918.87
68 690880.62 466027.46	143 690636.08 465884.16	168 690604.35 465920.46	297 690535.53 465918.10	109 690339.50 465922.78	184 690195.45 465919.52
69 690885.60 466030.80	144 690637.62 465884.87	169 690605.36 465921.17	298 690535.97 465918.81	110 690340.69 465923.45	185 690196.50 46592